

LEAD CUT  
LESS THAN 3mm

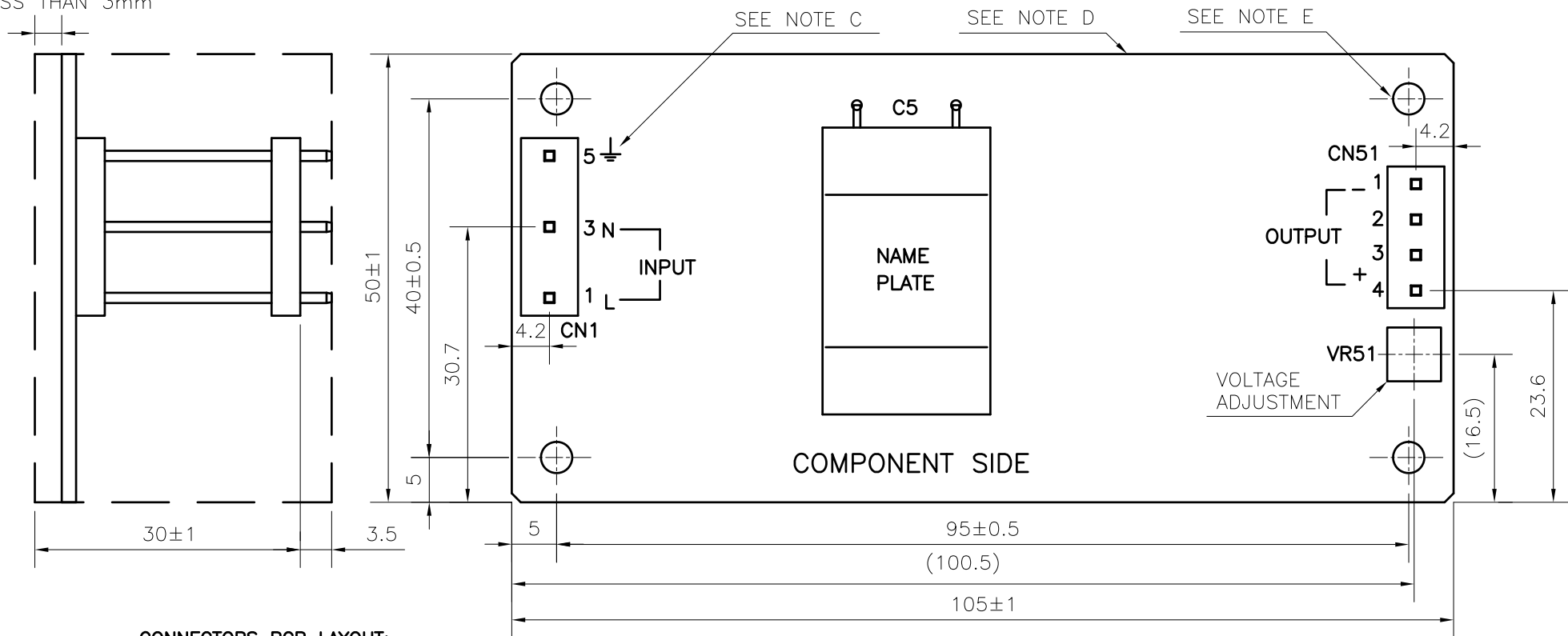

**CONNECTORS PCB LAYOUT:**

**1. INPUT CONNECTOR**

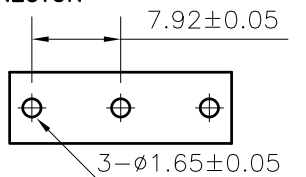

**2. OUTPUT CONNECTOR**

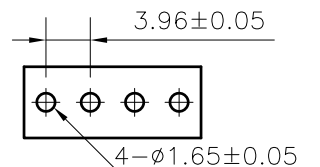

**NAME PLATE**

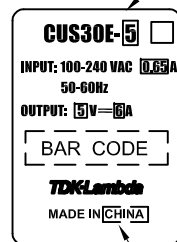

**NOTES**

- A: MODEL NAME, MAXIMUM OUTPUT POWER, NOMINAL OUTPUT VOLTAGE, MAXIMUM OUTPUT CURRENT, ARE SHOWN HERE IN ACCORDANCE WITH THE SPECIFICATIONS.
- B: COUNTRY OF MANUFACTURE WILL BE SHOWN HERE.
- C:  $\perp$  IS FOR SAFETY GROUND CONNECTION.
- D: TO KEEP THE DISTANCE MORE THAN 4mm BETWEEN PC-BOARD EDGE AND CUSTOMER'S CHASSIS.
- E: THE 4-Ø3.5 HOLES ARE CUSTOMER CHASSIS MOUNTING HOLES. IF THE APPLICATION FACE CRITICAL VIBRATION, CUSTOMER SHOULD USE FOUR STANDOFFS TO FIX POWER SUPPLY. DETAILS PLEASE REFER TO INSTRUCTION MANUAL.

(unit : mm)

MODEL NAME	CUS30E
<b>TDK-Lambda</b>	